

STANDARD Q

# COVID-19 IgM/IgG Combo Test

CE  
Cat. No : 09COV50G

- **Test time** : Within 15 mins
- **Specimen** : Whole blood/Serum/Plasma
- **Storage temperature** : 2-30°C/36-86°F
- **Pack size** : 40Tests/kit



## Benefit

 Suitable for point of care testing

 Room temperature storage

 Easy to use

 Fast results within 15 minutes

## Test Procedure

### Using Capillary whole blood

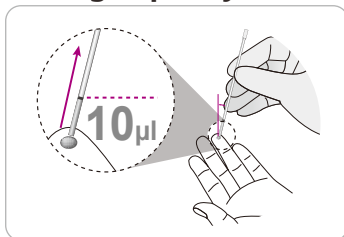

**1 Collecting of Specimen**  
Using a capillary tube, collect the 10 µl of capillary whole blood to the black line of the capillary tube.

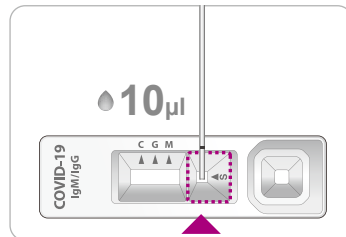

**2 Adding of Specimen**  
Add the collected capillary whole blood to the specimen well of the test device.

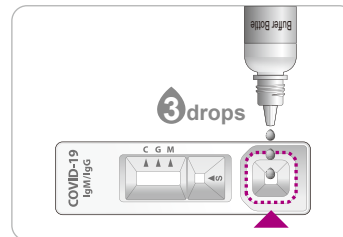

**3 Dropping of buffer**  
Add 3 drops (90µl) of buffer vertically into the buffer well of the test device.



**4 Reading Time**  
Read the test result at 10~15 minutes. Do not read test results after 15 minutes. It may give false results.

### Using serum/plasma/venous whole blood

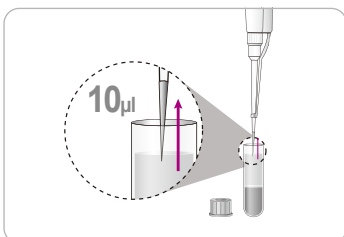

**1 Collecting of Specimen**  
Using a micropipette, collect the 10µl of serum, plasma or venous whole blood with micropipette.

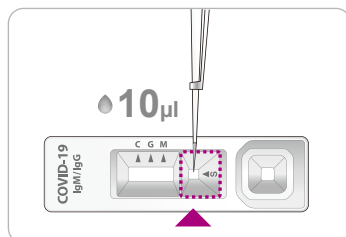

**2 Adding of Specimen**  
Add the collected serum, plasma or venous whole blood to the specimen well of the test device.

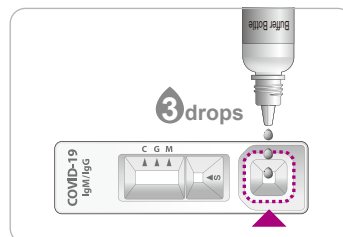

**3 Dropping of buffer**  
Add 3 drops (90µl) of buffer vertically into the buffer well of the test device.



**4 Reading Time**  
Read the test result at 10~15 minutes. Do not read test results after 15 minutes. It may give false results.

## Interpretation of Test Result

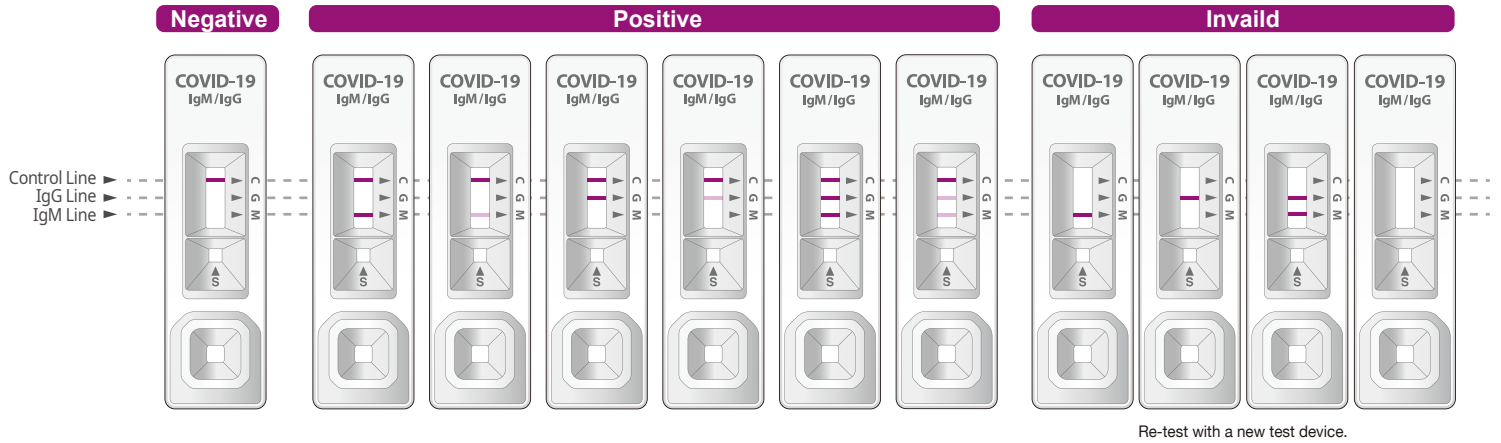

1. A colored band will appear in the top section of the result window to show that the test is working properly. This band is control line (C).
  2. A colored bands will appear in the lower section of the result window. These bands are each test line of IgM/IgG (M, G).
  3. Even if the control line is faint, or the test line isn't uniform, the test should be considered to be performed properly and the test result should be interpreted as a positive result.
- \* **STANDARD Q COVID-19 IgM/IgG Combo Test may cross-react with antibody against SARS-CoV-1.**
  - \* **Results from antibody testing should not be used as the sole basis to diagnose or exclude SARS-CoV-2 infection or to inform infection status.**
  - \* **Positive results should be considered in conjunction with the clinical history, RT-PCR results and other data available.**

## Ordering Information

### STANDARD Q COVID-19

Cat. No.	Product	Storage temperature	Tests/kit	Kits/carton	Carton size (W/D/H)
09COV30D	STANDARD Q COVID-19 Ag Test	2-30°C/36-86°F	25	30	550 x 460 x 390 mm
09COV12B	STANDARD Q COVID-19 IgM/IgG Duo Test	2-30°C/36-86°F	20	40	515 x 515 x 370 mm
09COV50G	STANDARD Q COVID-19 IgM/IgG Combo Test	2-30°C/36-86°F	40	40	515 x 515 x 370 mm
10COVC10	STANDARD COVID-19 Ag Control	2-30°C/36-86°F	10	20	155 x 390 x 110 mm
10COVC20	STANDARD COVID-19 IgM/IgG Control	2-30°C/36-86°F	10	20	215 x 390 x 110 mm

## MEMO